



MANUAL INSTALACION

ZENLINE

VERTICAL UP

1

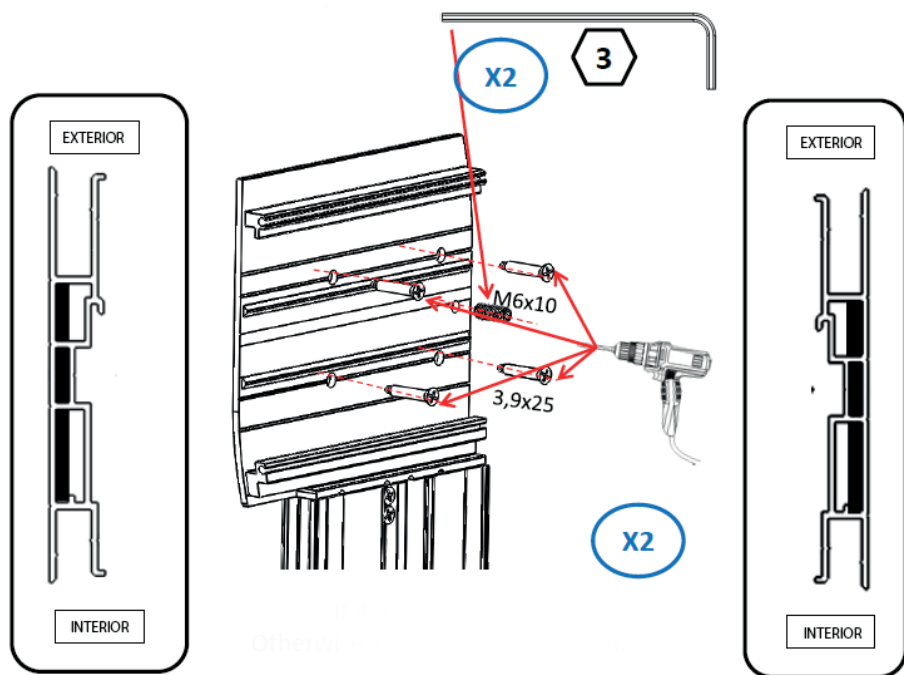

1.1

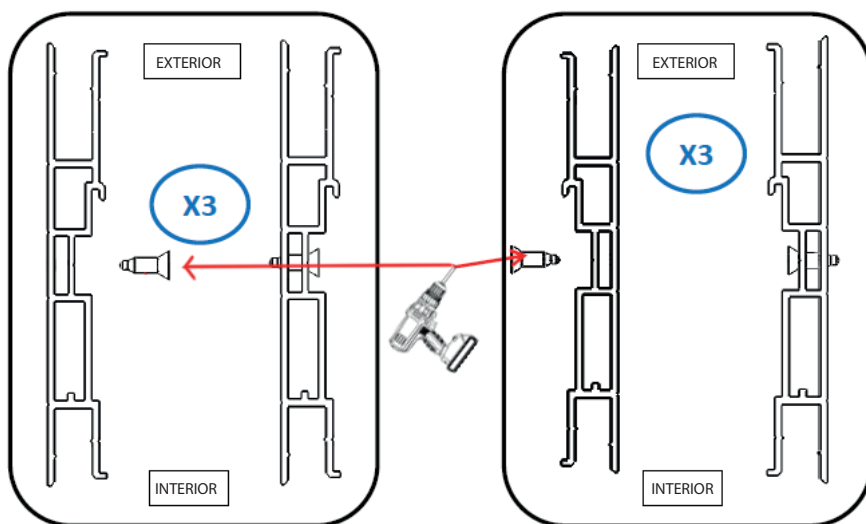
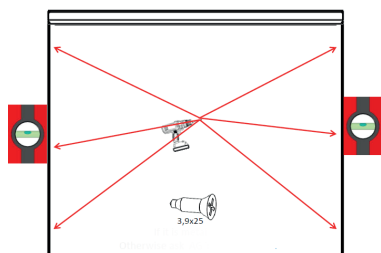

2

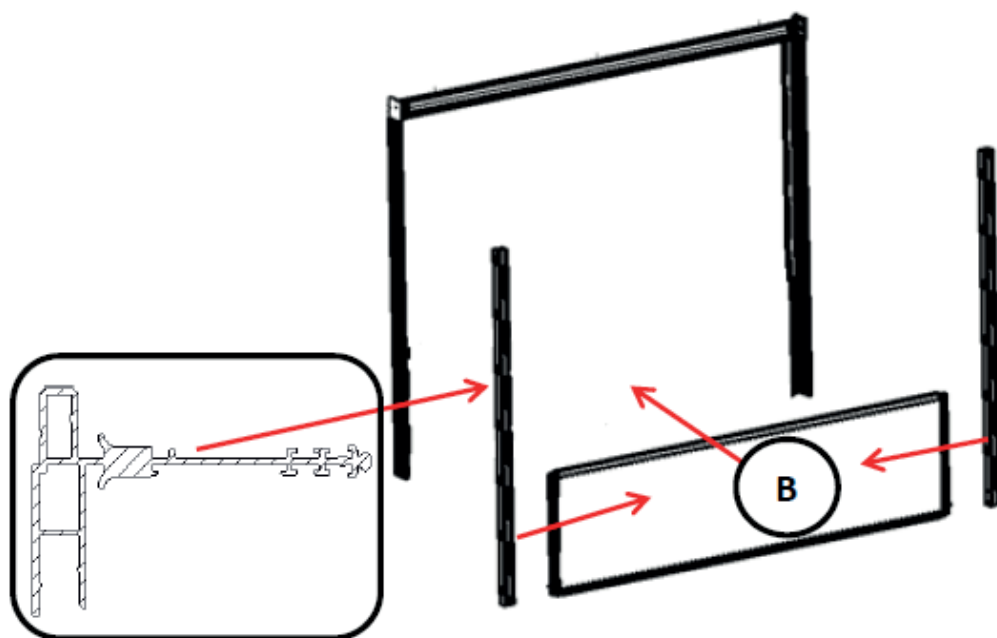

2.1

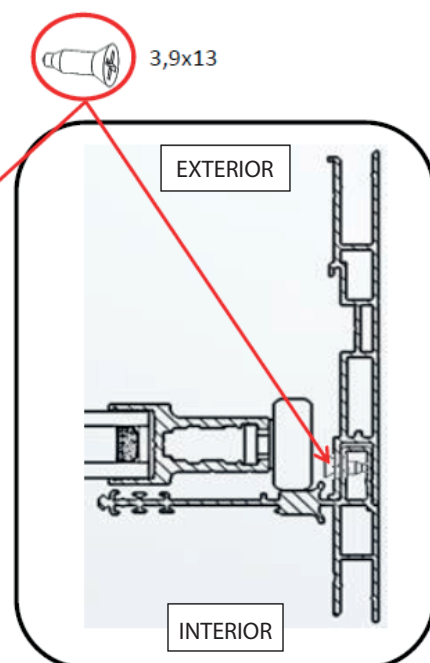
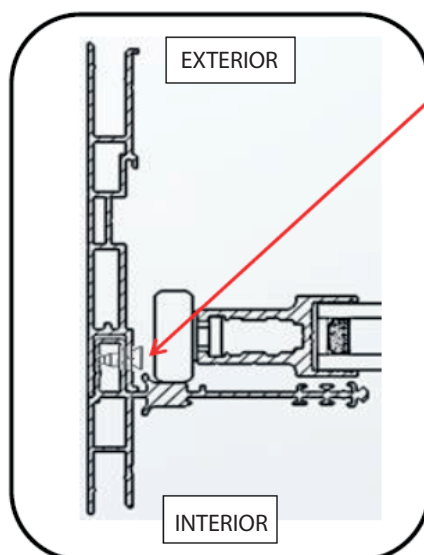
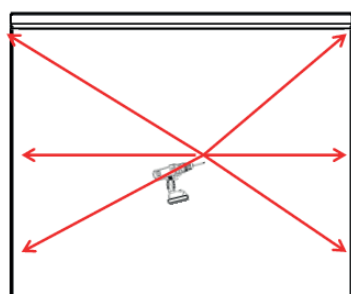

2.2

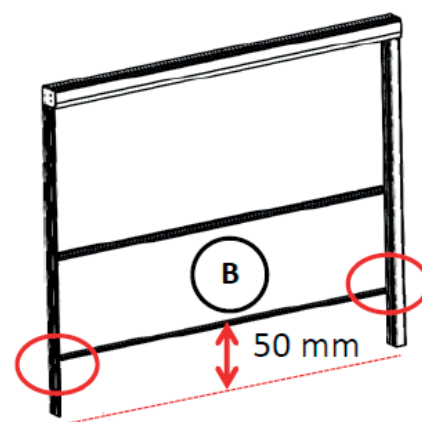
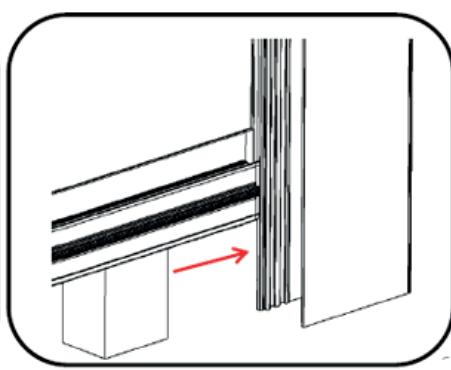
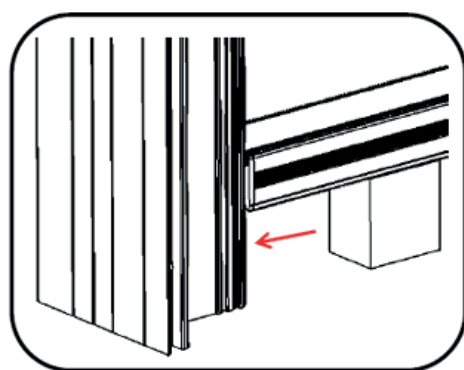

3

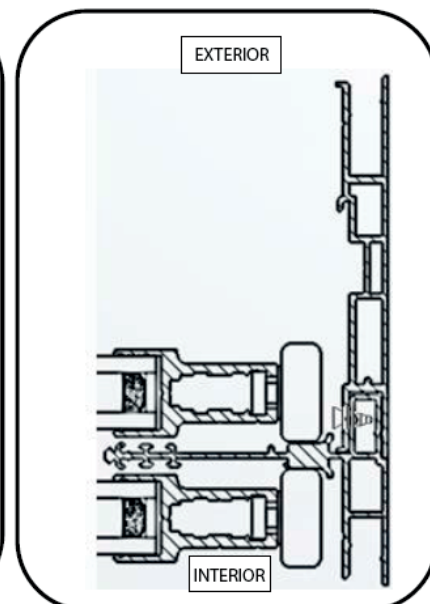
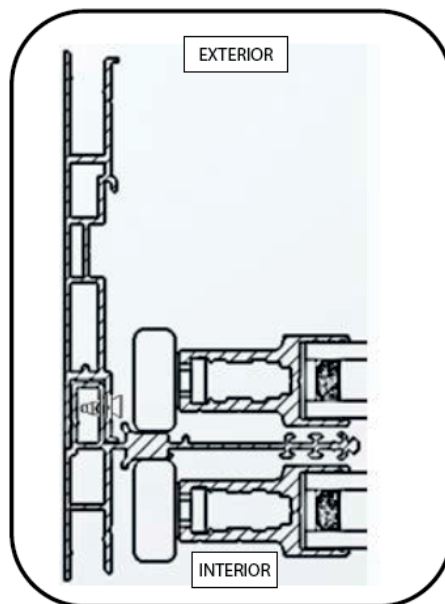
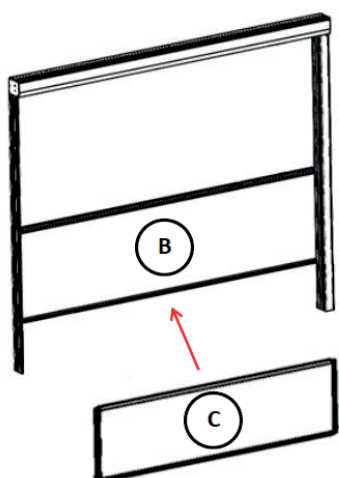

3.1

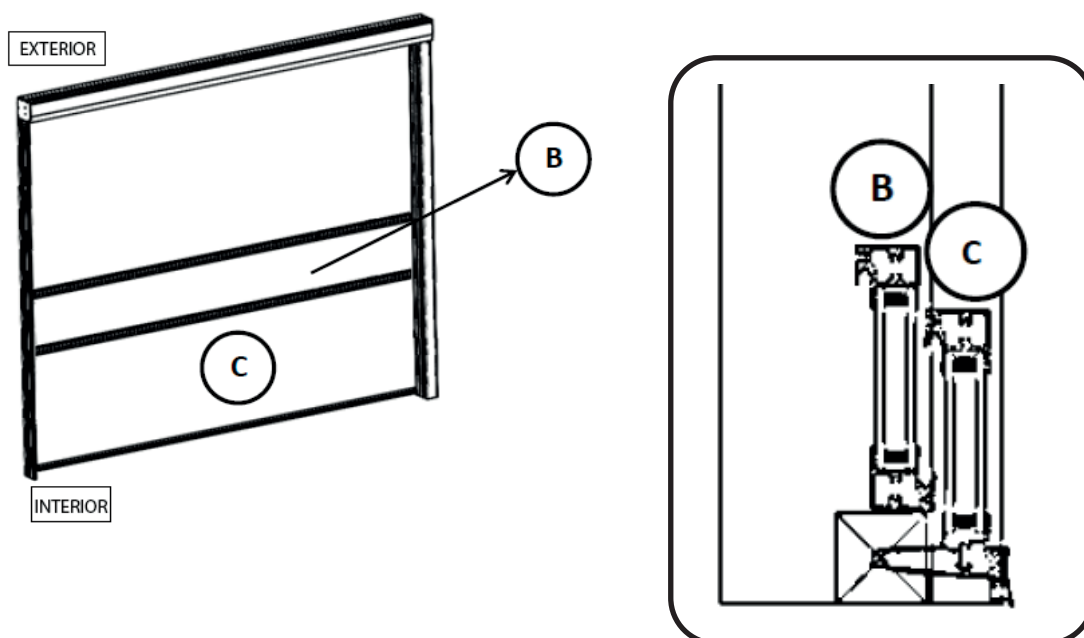

4

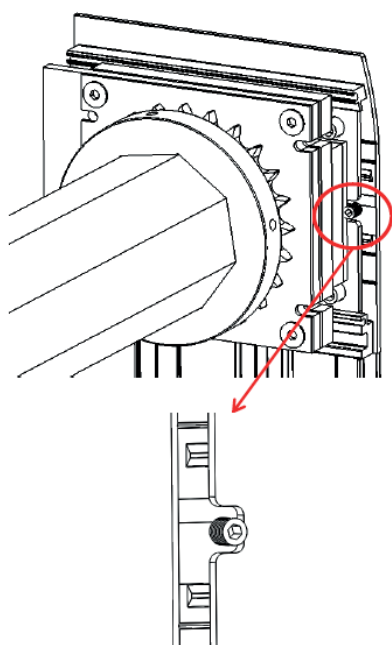
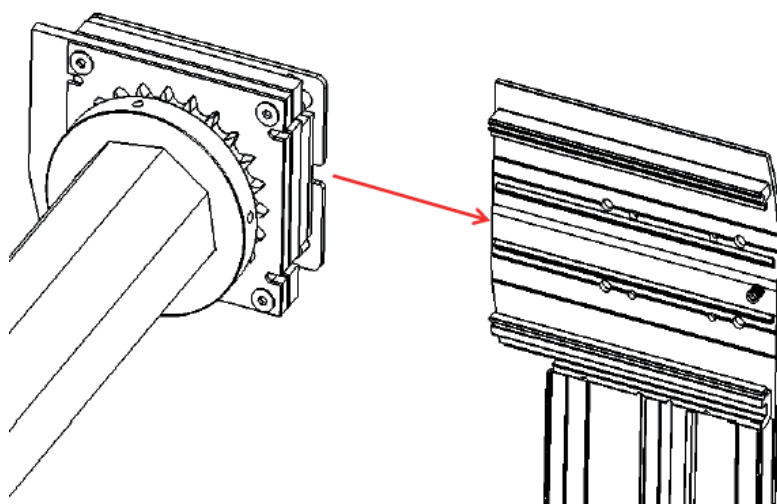

4.1

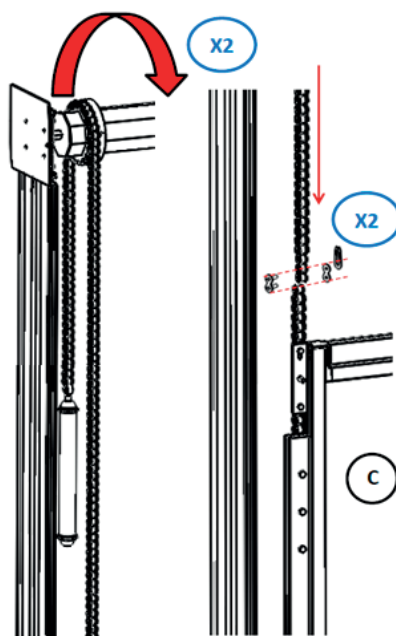

4.2

4.3

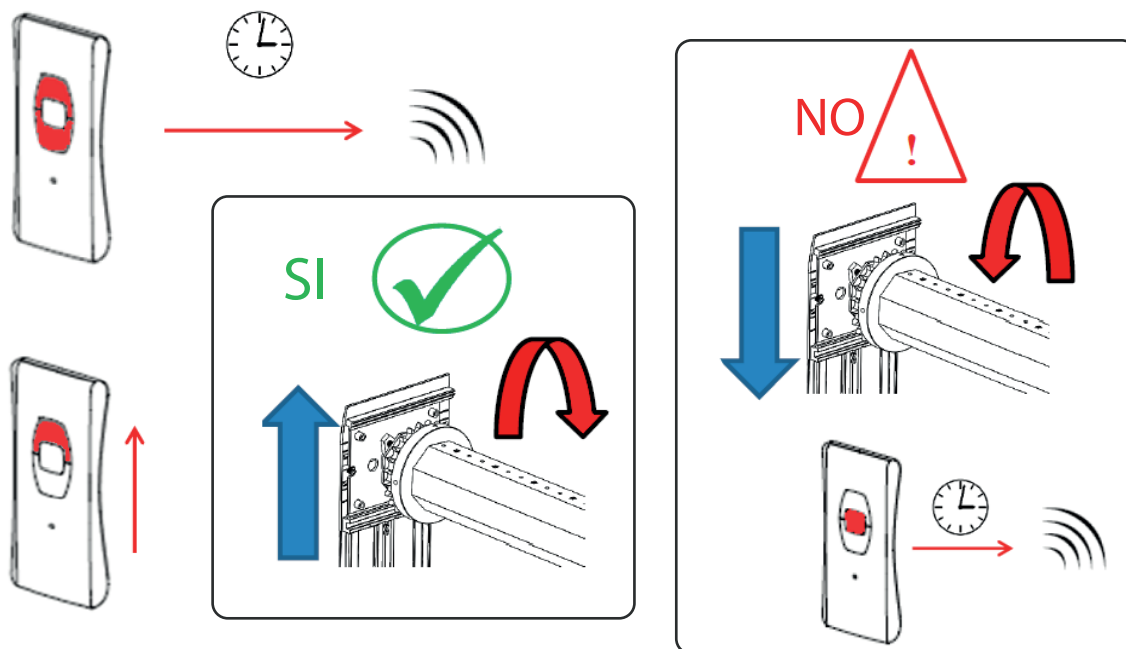

5

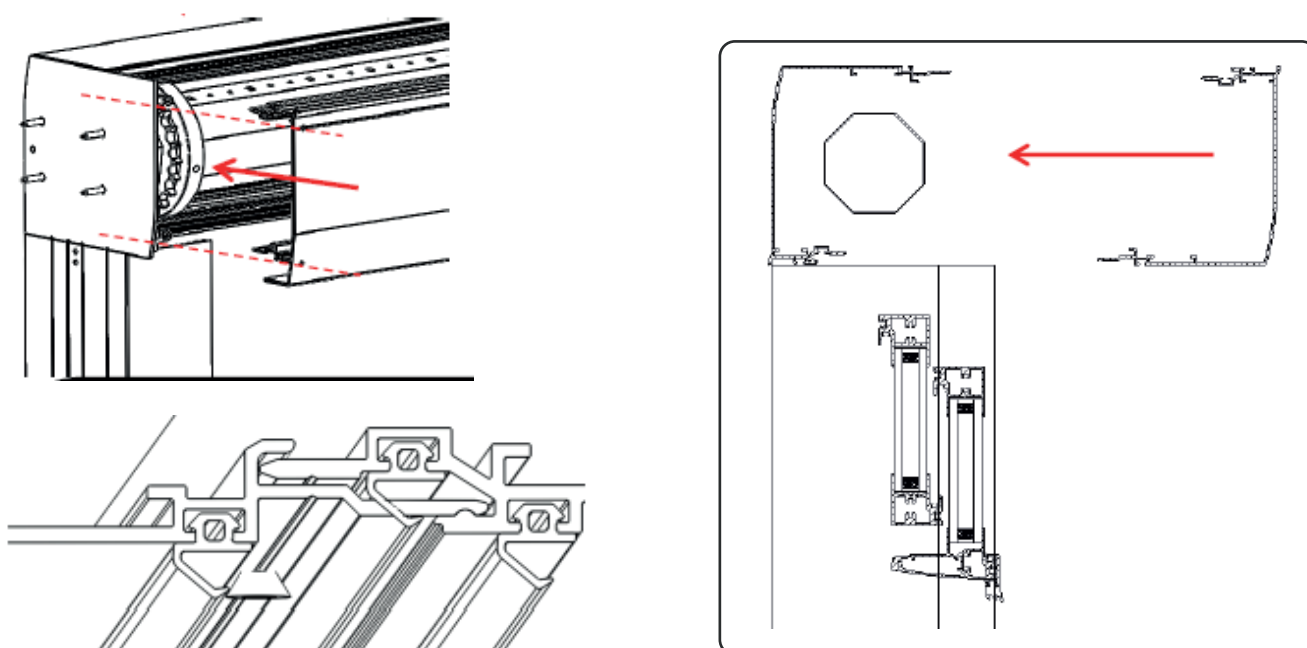

5.1

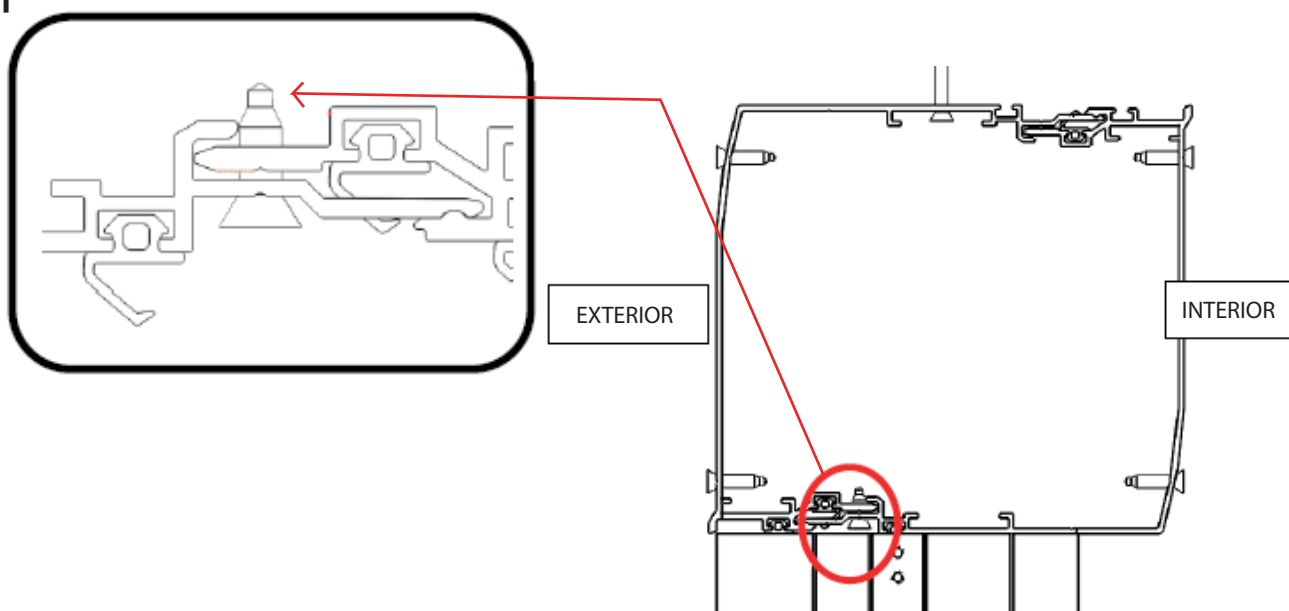

5.2

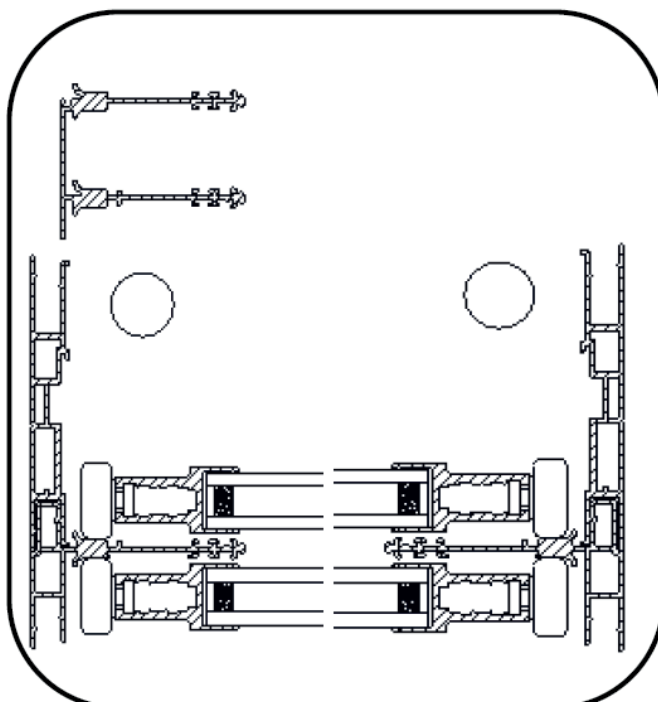

5.3

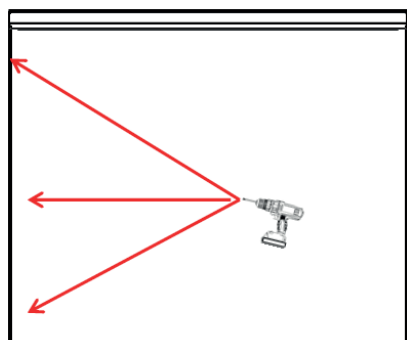
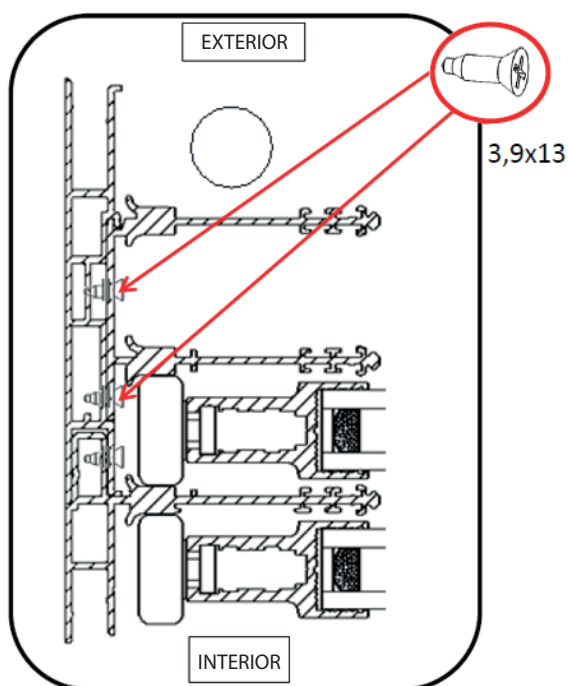

6

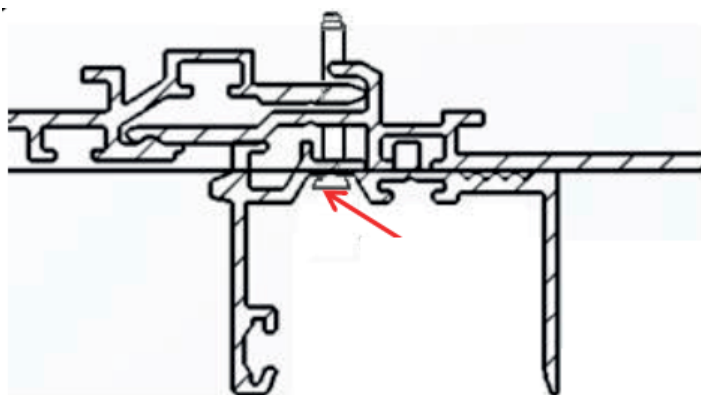
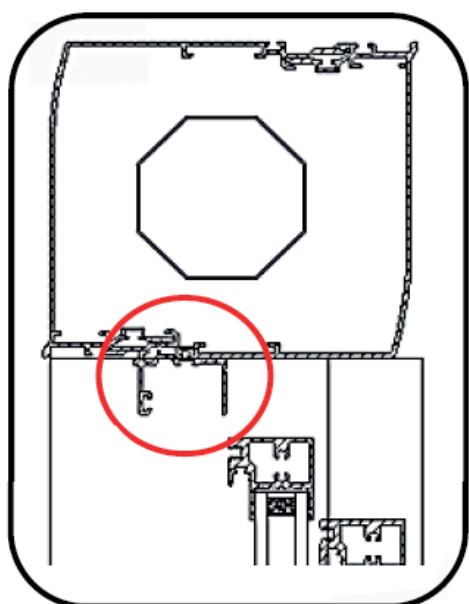

6.1

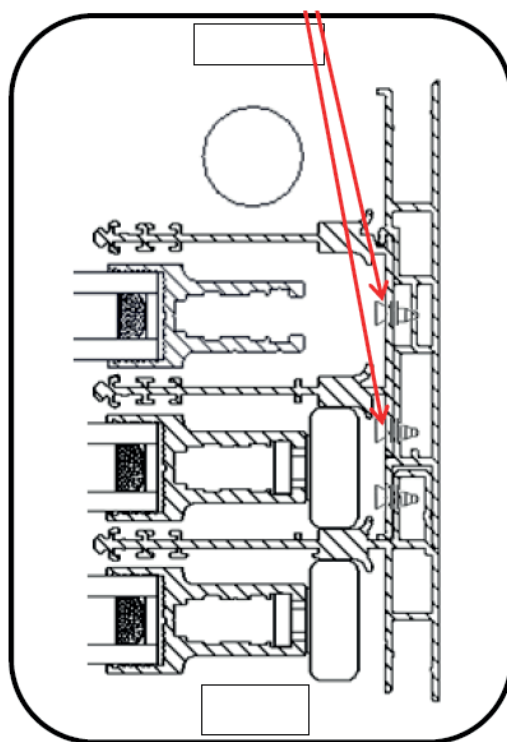
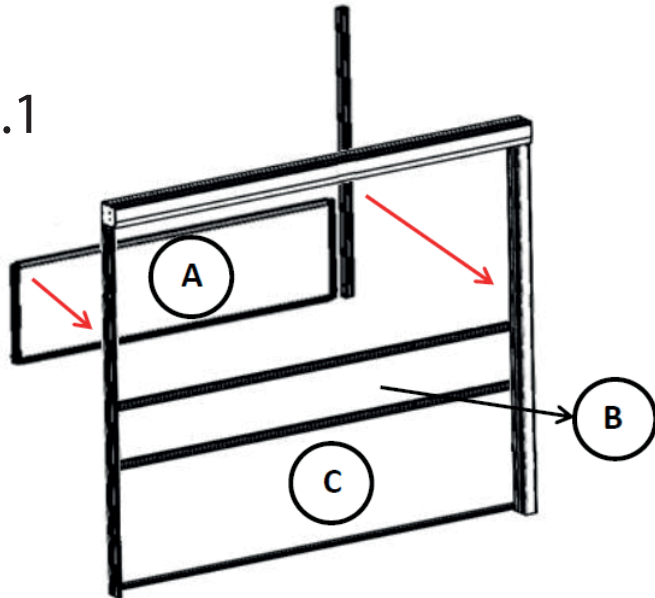

6.2

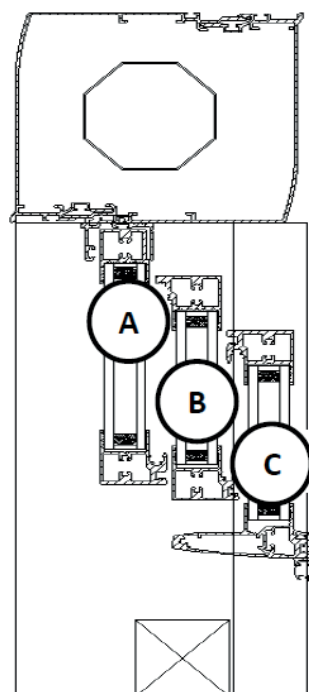
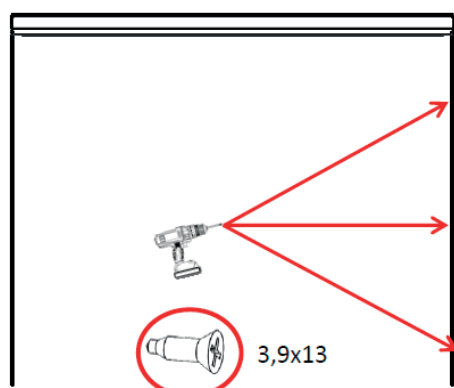

6.3

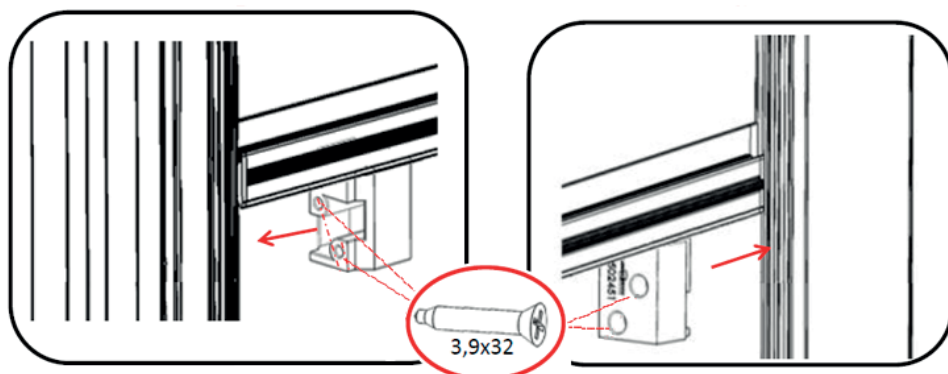
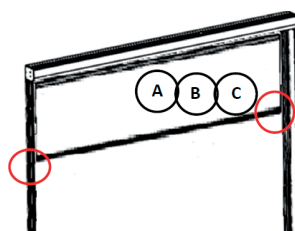

7

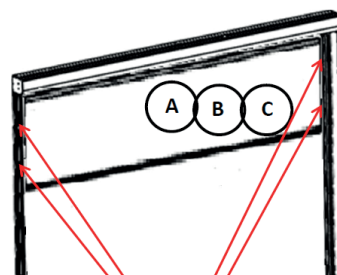
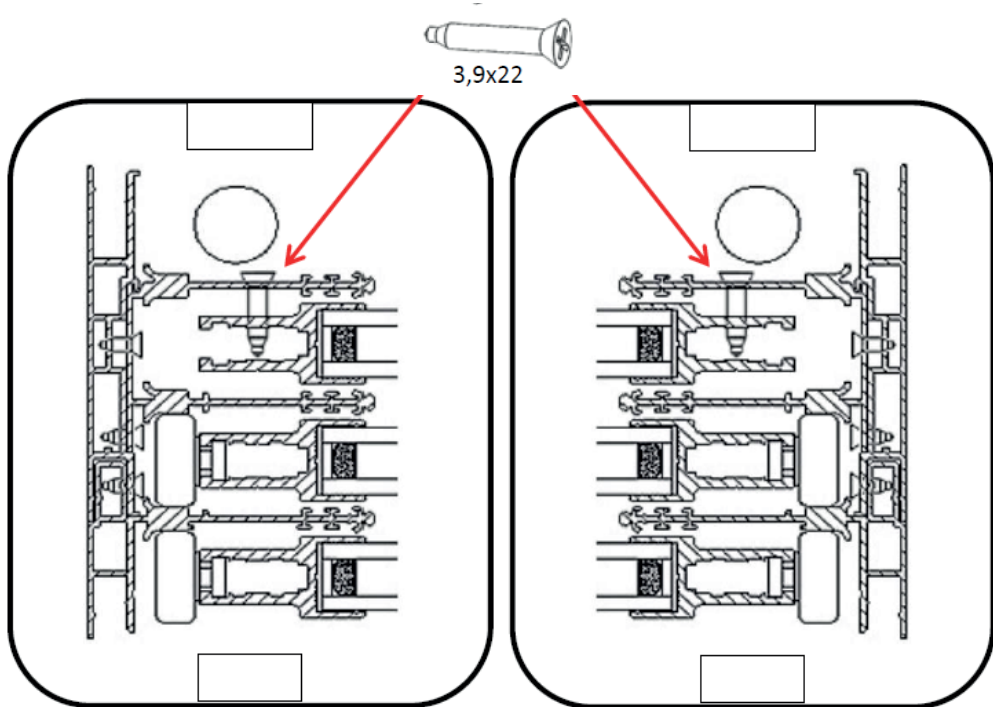

7.1

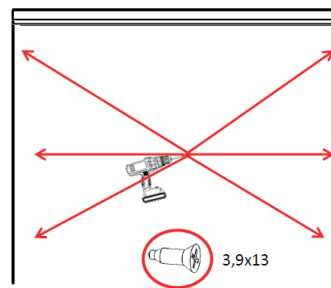
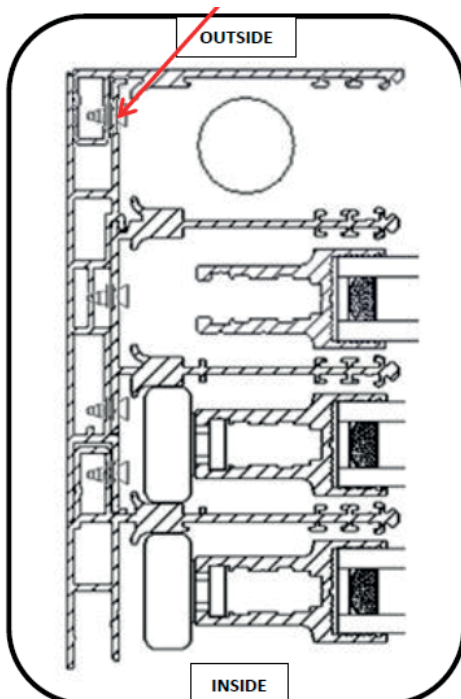
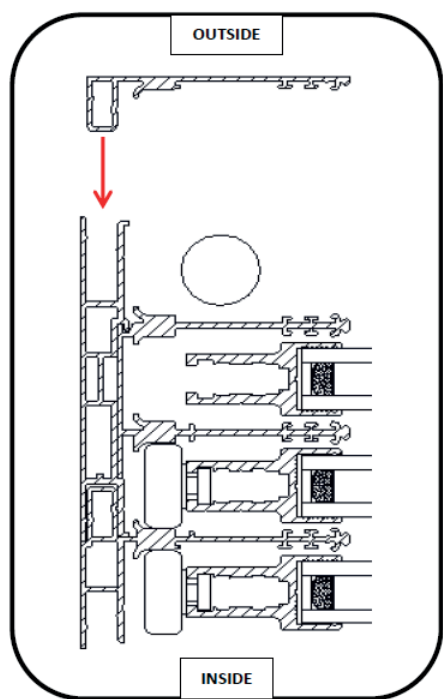

7.2

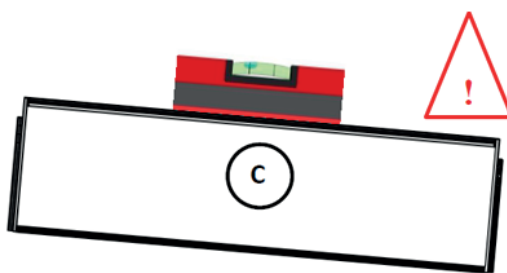
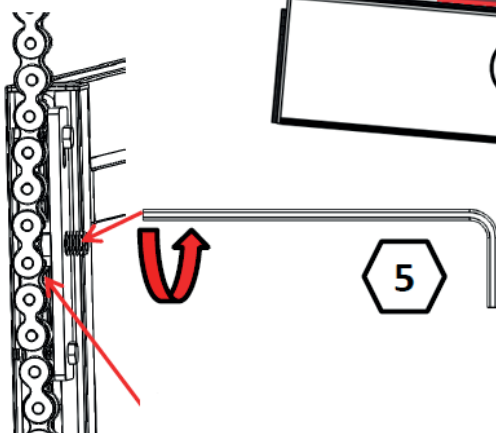
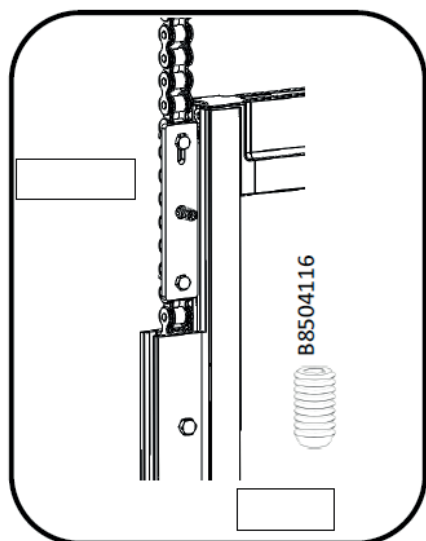

8

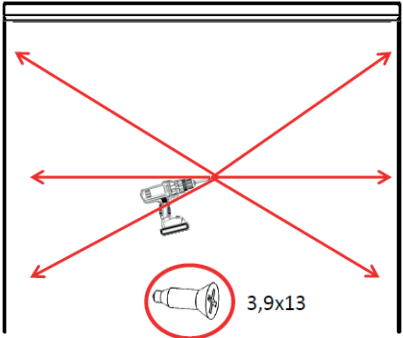
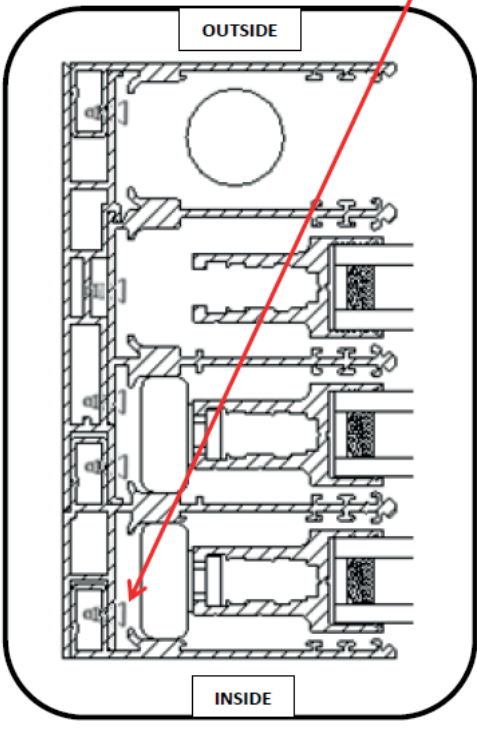
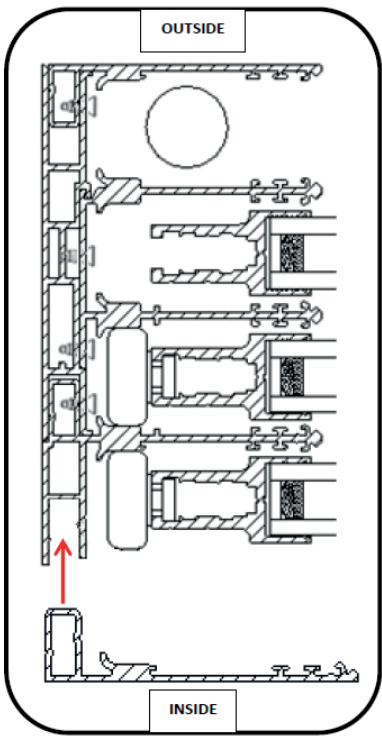

8.1

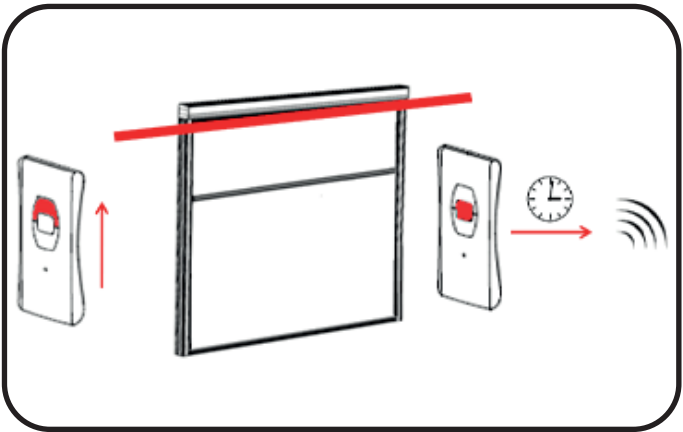
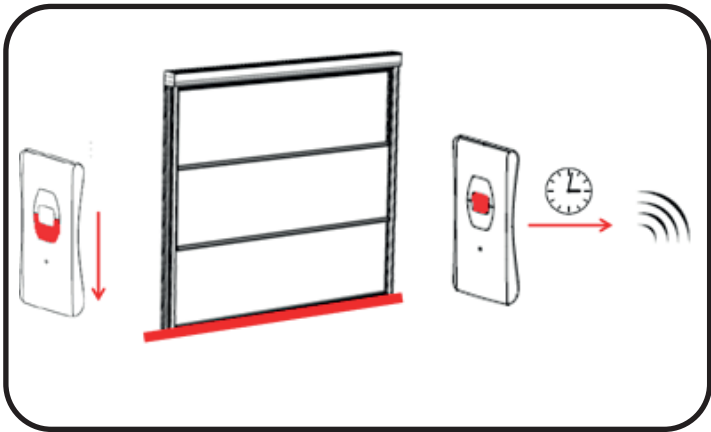
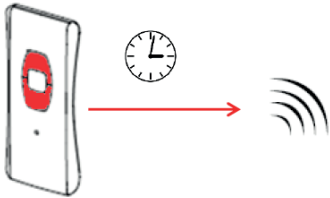
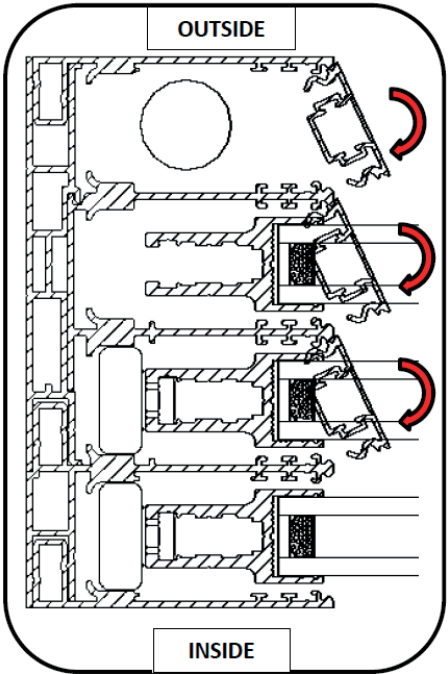
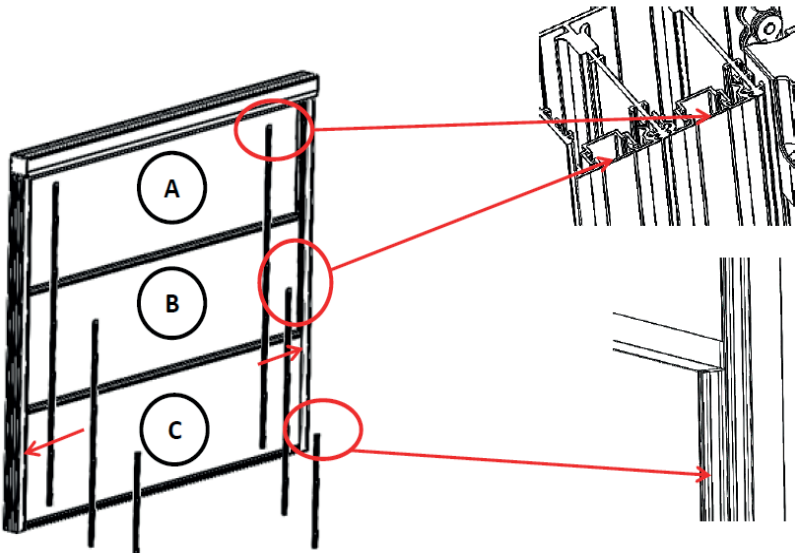



5156393C

ES

Sunilus (screen) io

Breve guía de instalación

MANUAL TRADUCIDO

El manual de instrucciones completo está disponible en línea en www.somfy.info**somfy®**

Desde la aplicación
"Help me by Somfy"
escanee el código QR
aquí para encontrar
instrucciones de ajuste
completas.



"Help me by Somfy"
disponible en tiendas



	230 V ~50 Hz			
L	Marrón			
N	Azul			
⏏	Verde y amarillo			

1 PREPROGRAMACIÓN DEL PUNTO DE MANDO

SENTIDO DE ROTACIÓN

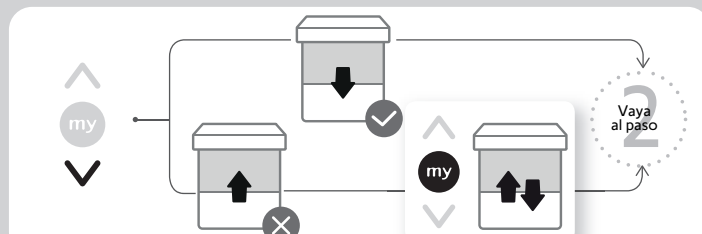
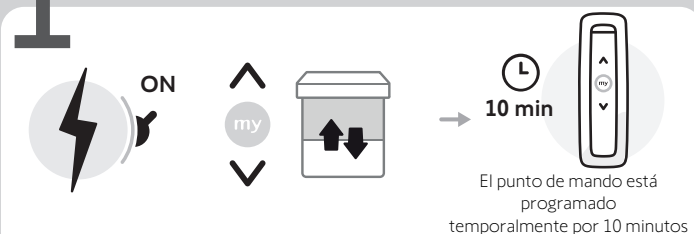

2 AJUSTE DE FINALES DE CARRERA

MODO MANUAL

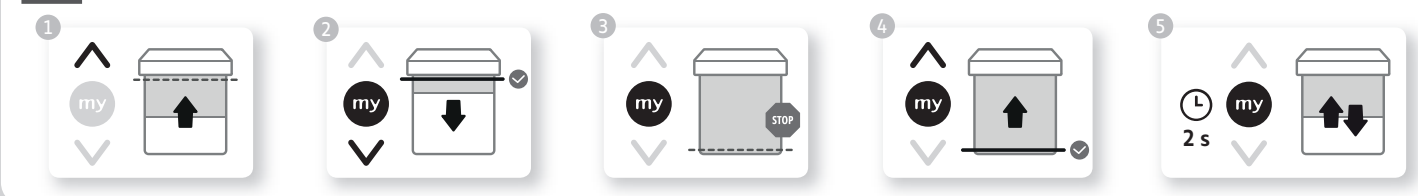

3 VINCULACIÓN

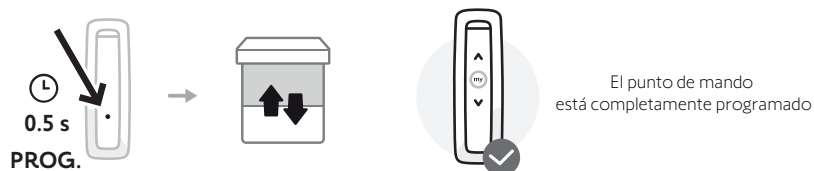

4 USO

Esta motorización no requiere ninguna operación de mantenimiento.

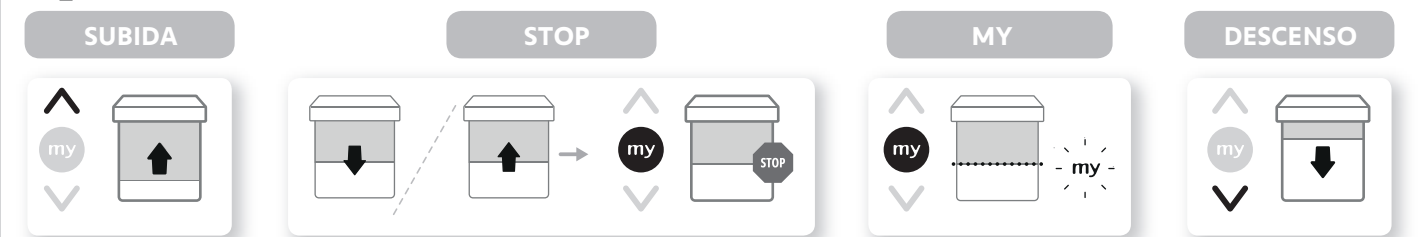

5 REAJUSTE DE LA MOTORIZACIÓN

⚠ Realice el doble corte de corriente solamente en el producto que quiera hacer el reset.

Esta operación de reset eliminará todos los puntos de mando, sensores y ajustes del final de carrera, y reiniciará la posición preferida (my) de la motorización.

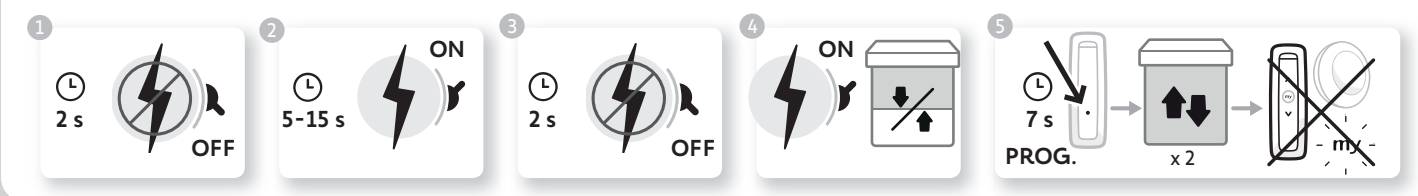

ZENLINE

MINIMAL OUTDOOR

C/ Conradors, 1A - 07141 Marratxí